

Folding Table NTseries

Instructions for Use



okamura

Safety Instruction

【 Keep this operation manual 】

⚠ Caution Please follow the following safety regulations. Failure may cause serious injuries to user and may damage or tip over the product.

⚠ Caution

Do not handle roughly, or use improperly.

- Do not use as a step or a carrier.
- Do not sit on the tabletop.

Only move the product in the longitudinal direction.

- Take care of moving forwards/backwards when nesting or setting-up.

Do not handle the lever during use.

- Check if table top is properly locked when flipping up or down.

Do not put fingers or hands in movable spots or gaps. Especially the mechanical part and the modesty panel connecting part in the rear side of table top may cause pinching.

Do not leave loose bolts or screws. Tighten when occur.

Do not use the product when any components have loosed.

Do not disassemble or repair on your own. Please contact the dealer when needed.

No remodeling. Okamura will have no responsibility for any disadvantage caused by remodeling.

Follow the maximum load to the product.

For Setting

Please follow the following setting instruction. Failure may cause serious damage to the product.

Indoor use only

No outdoor or waterfront use.

Avoid direct sunlight.

When placing alongside windows, use curtain or blind to avoid from direct sunlight.

Avoid high temperature, high humidity, or extraordinary aridity.

Do not place product under heater or air-conditioner exhausting high temperature air.

Place on flat floor.

Name of Components

Mechanical Part / Modesty Panel Section

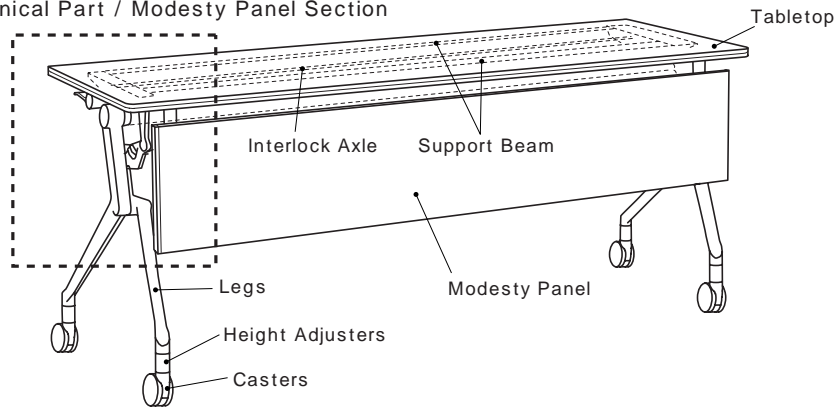

Mechanical Part / Modesty Panel Section

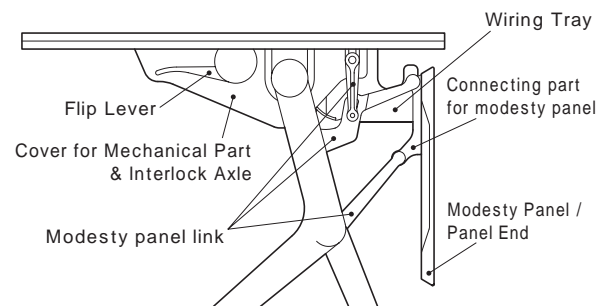

Shelf board (Option)

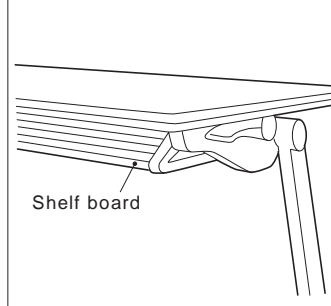

Operation Guide

Tabletop - Folding / Unfolding

Fold/unfold using the Flip Lever.

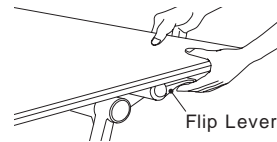

Folding

1. Lift the lever by one hand and hold up the tabletop with the other hand.
2. Release the lever during folding motion.
3. Hold up the tabletop until click sound is heard.

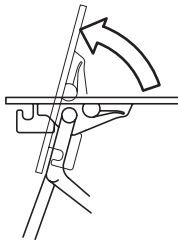

Unfolding

1. Hold the tabletop by one hand and handle the lever by the other hand.
2. Gently hold down tabletop, and release the lever.
3. Push down the tabletop until click sound is heard.

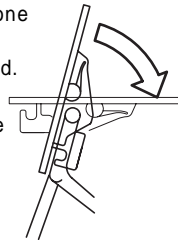

Operation Guide

Moving the table

Hold the edge of tabletop.

The table can be moved either in folded or unfolded condition.



Caution

Ensure that caster lock is released. Move the product in the longitudinal direction. In case of nesting or changing layout, be cautious not to lose balance and tipping over.

Height Adjuster / Caster Lock Lever

Height Adjuster (range 10mm)

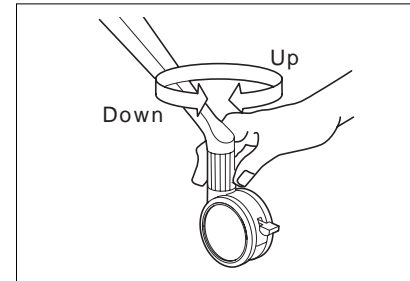

Caster Lock Lever

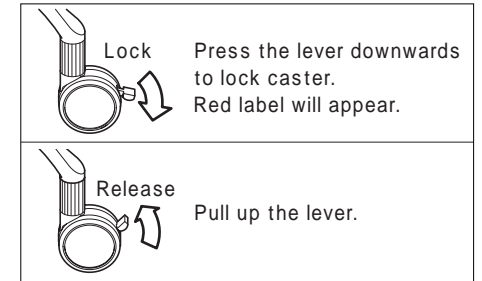

Wiring Tray

Cables can be stored in the wiring tray.

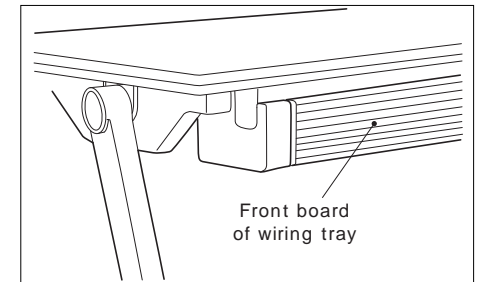

Push down the front board for storing cables.

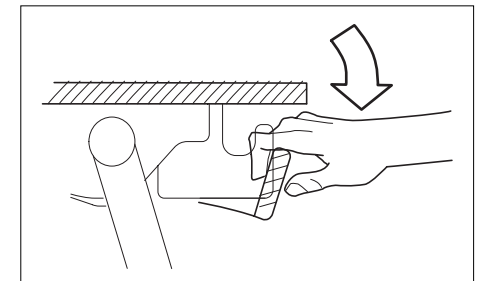

Operation Guide

For modesty panel models

Opening modesty panel

Lower the modesty panel by pressing the pointed lever on both end of modesty panel.

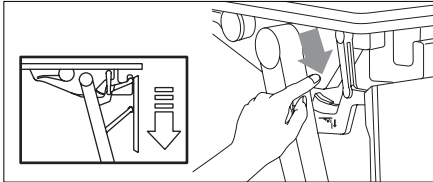

Closing modesty panel

Hold bottom of the panel and lift it up until click sound is heard.

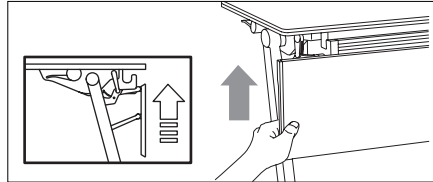

Caution

Do not put your fingers or hands in movable parts or gaps.

Storage

Increase space efficiency by nesting tables.

Caution

Take extra care not to tip over the table or hit the legs when storing.

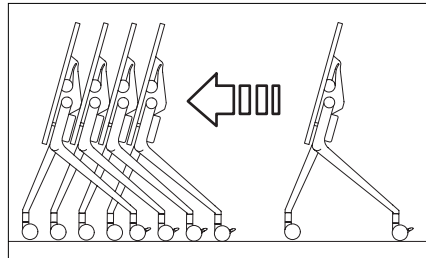

Shelf board (Option)

Documents can be placed. (A4 size favourable).

Caution

Do not forcibly put large items into the shelf.

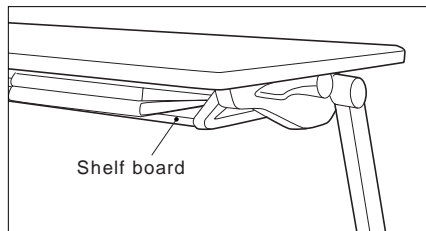

Maximum Loading Weight (uniformly-distributed weight)

Tabletop	60kg
Shelf board	10kg

Uniformly-distributed weight is to distribute the weight equally over the entire surface.

FAQ

Question	Check	Correspondence	See
Casters do not move smoothly.	Is it tangled with lint or wool?	Remove foreign object or replace with new caster.	—
	Is the lever of casters pushed down and locked?	Lift up the lever and unlock the casters.	Height Adjuster / Caster Lock Lever section (P.3)
Tabletop is not stable.	Is the Flip up/down lever locked properly?	Hold the lever and push up/down the tabletop until clicking sound is heard.	Tabletop (Flip Up / Down) section (P.2)
	Is the table used on flat floor?	Twist the height adjuster and level tabletop.	Height Adjuster / Caster Lock Lever section (P.3)
Table makes noise.	From which part of the table can noise be heard?	Please contact our official dealer.	—

For Maintenance

Be sure to follow the instructions below, Failure may cause disadvantages. Okamura will have no responsibility if the instructions are not followed.

Precautions for use and maintenance

If liquid spilled on the table, wipe it off immediately.

- Especially for alcohol, thinner, benzene etc., they may cause discoloration, deformation, or damage to the table.

Regular maintenance for loose bolts and screws is recommended.

- Tighten the loose bolts/screws if the table is unstable due to the bolts/screws.

Tips for long-life use is frequent maintenance. Please contact our official dealer for regular maintenance.

Care

For daily care

Use a dry soft cloth.

For stained part

Use neutral detergent (1-3%) on well wrung soft cloth. Completely remove detergent with dry soft cloth after cleaning.

Precautions

Do not use a dryer or a sharp tool for this table. It may cause scratches or deformation.

No chemical wipe. It may cause discoloration. When using detergents, please make sure that it does not cause discoloration by trying it on invisible parts.



Materials & Finishes

	Part	Material	Finish
Tabletop	Surface	Melamine laminate	—
	Core	Particle board	—
	Edge	ABS ABS	—
Mechanical Part	Body	Steel	Resin backing coating
	Bearing	Polyacetal POM	—
	Connecting Pipe	Steel pipe	Resin backing coating
	Cover	ABS ABS	—
	Support Beam	Steel pipe	Resin backing coating
	Lift Lever	ABS ABS	—
	Interlock Axle	Steel pipe	Resin backing coating
Leg	Body	Aluminum	Resin backing coating
	Caster	Polyamide PA	—
	Height Adjuster	Polyamide PA	—
Modesty Panel	Body	ABS ABS	—
	Panel End	ABS ABS	—
	Connecting Part	Polyamide PA	—

Resin parts are labeled with material code for easy recycling.

okamura

OKAMURA CORPORATION

INTERNATIONAL SALES & MARKETING DIVISION
 6-1-20, Akasaka, Minato-ku, Tokyo 107-0052, JAPAN
 Tel : +81-3-5561-4085 Fax : +81-3-5561-4086
<http://www.okamura.co.jp/>

